

DW100 POMPA YEDEK PARA LİSTESİ

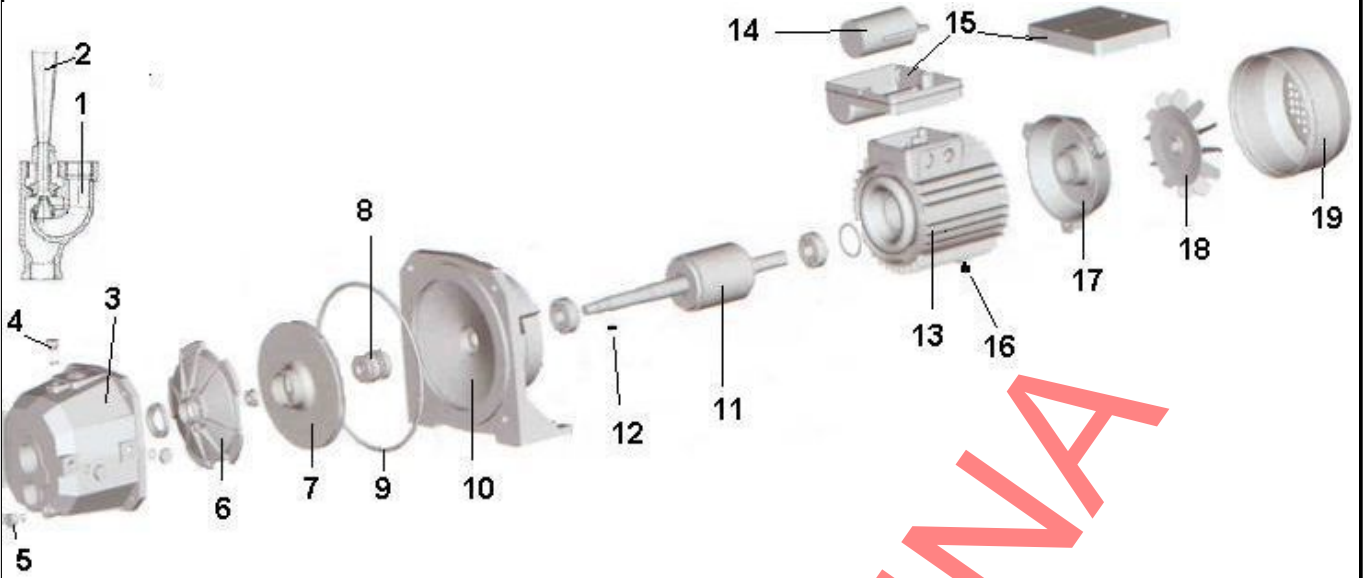

RESİM	POMPA MODELİ	YEDEK PARA ADI	
1	DW100	ENJEKTÖR (venturisiz)	EJECTOR
2	DW100	ENJEKTÖR BORUSU (enjektör venturi)	EJECTOR PIPE
3	DW100	ÖN GÖVDE	PUMP FRONT BODY
4	DW100	VİDA	SCREW (AIR TAKEING)
5	DW100	VİDA	SCREW (WATER DRAINING)
6	DW100	DİFİZÖR	DIFFISOR
7	DW100	SU PERVANESİ	IMPELLER
8	DW100	MEKANİK SALMASTRA	MECHANICAL SEAL
9	DW100	O RİNG	O RING
10	DW100	ARKA GÖVDE	ABOVE COVER
11	DW100	ROTÖR + SAFT	ROTOR (WITH WELDING S/S SHAFT)
12	DW100	KAMA	KEY
13	DW100	MÖTÖR GÖVDESİ (STATOR)	STATOR (WITH MOTOR BODY)
14	DW100	KONDANSATÖR	CAPASITOR
15	DW100	ELEKTRİK KUTUSU	ELECT.(Terminal)BOX
16	DW100	AYAK	MOTOR BODY BACK FOOT
17	DW100	ARKA KAPAK	MOTOR BACK COVER
18	DW100	HAVA FANI	AIR FAN
19	DW100	HAVA FAN KAPAĐI	AIR FAN COVER

2DW150 POMPA YEDEK PARÇA LİSTESİ

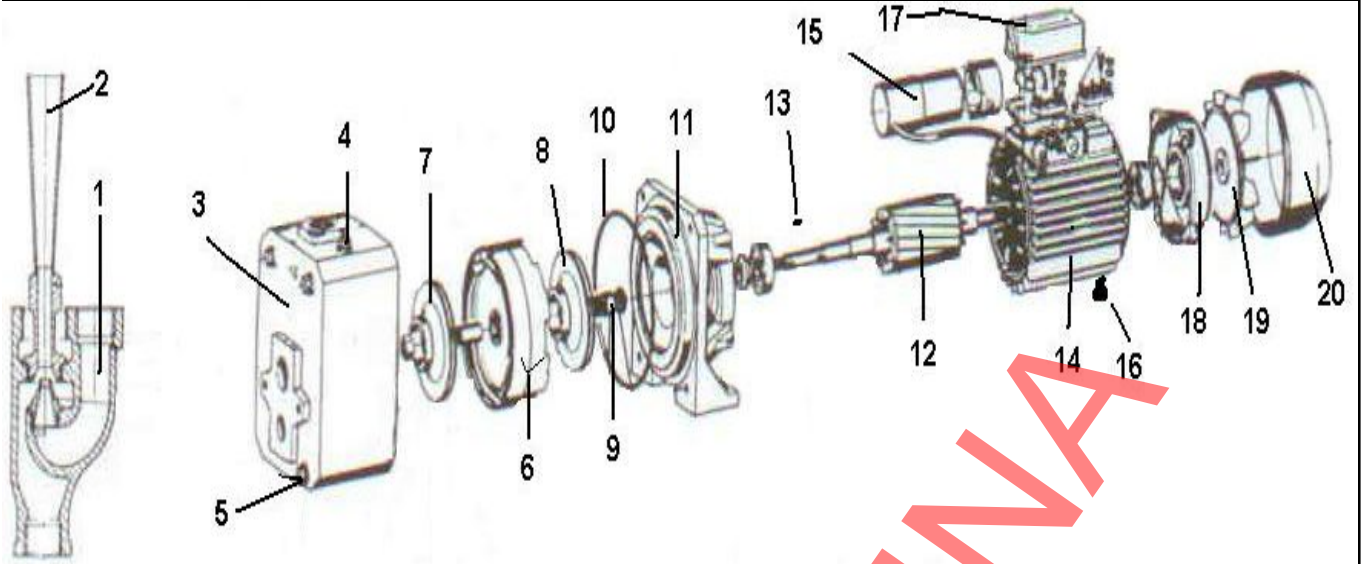

RESİM	POMPA MODELİ	YEDEK PARÇA ADI	
1A	2DW150	ENJEKTÖR (venturisiz)	EJECTOR
1B	2DW150	ENJEKTÖR (venturisiz)	EJECTOR
2	2DW150	ENJEKTÖR BORUSU (enjektör venturi)	EJECTOR PIPE
3	2DW150	ÖN GÖVDE	PUMP FRONT BODY
4	2DW150	VİDA	SCREW (AIR TAKEING)
5	2DW150	VİDA	SCREW (WATER DRAINING)
6	2DW150	DİFİZÖR	DIFFISOR
7	2DW150	SU PERVANESİ	IMPELLER
8	2DW150	SU PERVANESİ	IMPELLER
9	2DW150	MEKANİK SALMASTRA	MECHANICAL SEAL
10	2DW150	O RİNG	O RING
11	2DW150	ARKA GÖVDE	ABOVE COVER
12	2DW150	ROTOR + ŞAFT	ROTOR (WITH WELDING S/S SHAFT)
13	2DW150	KAMA	KEY
14	2DW150	MOTOR GÖVDESİ (STATOR)	STATOR (WITH MOTOR BODY)
15	2DW150	KONDANSATÖR	CAPASITOR
16	2DW150	AYAK	MOTOR BODY BACK FOOT
17	2DW150	ELEKTRİK KUTUSU	ELECT.(Terminal)BOX
18	2DW150	ARKA KAPAK	MOTOR BACK COVER
19	2DW150	HAVA FANI	AIR FAN
20	2DW150	HAVA FAN KAPAĞI	AIR FAN COVER